

GRANT COUNTY Washington 2008 Tax Foreclosure Properties

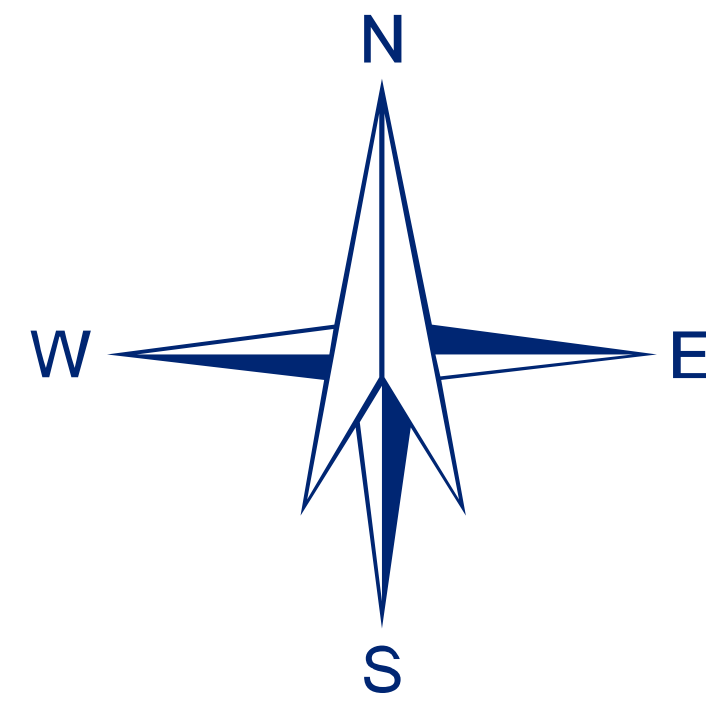

This map is current as of 5:00 P.M.-10/16/08

**For more current information contact
Grant County Treasurer's Office
(509) 754-2011**

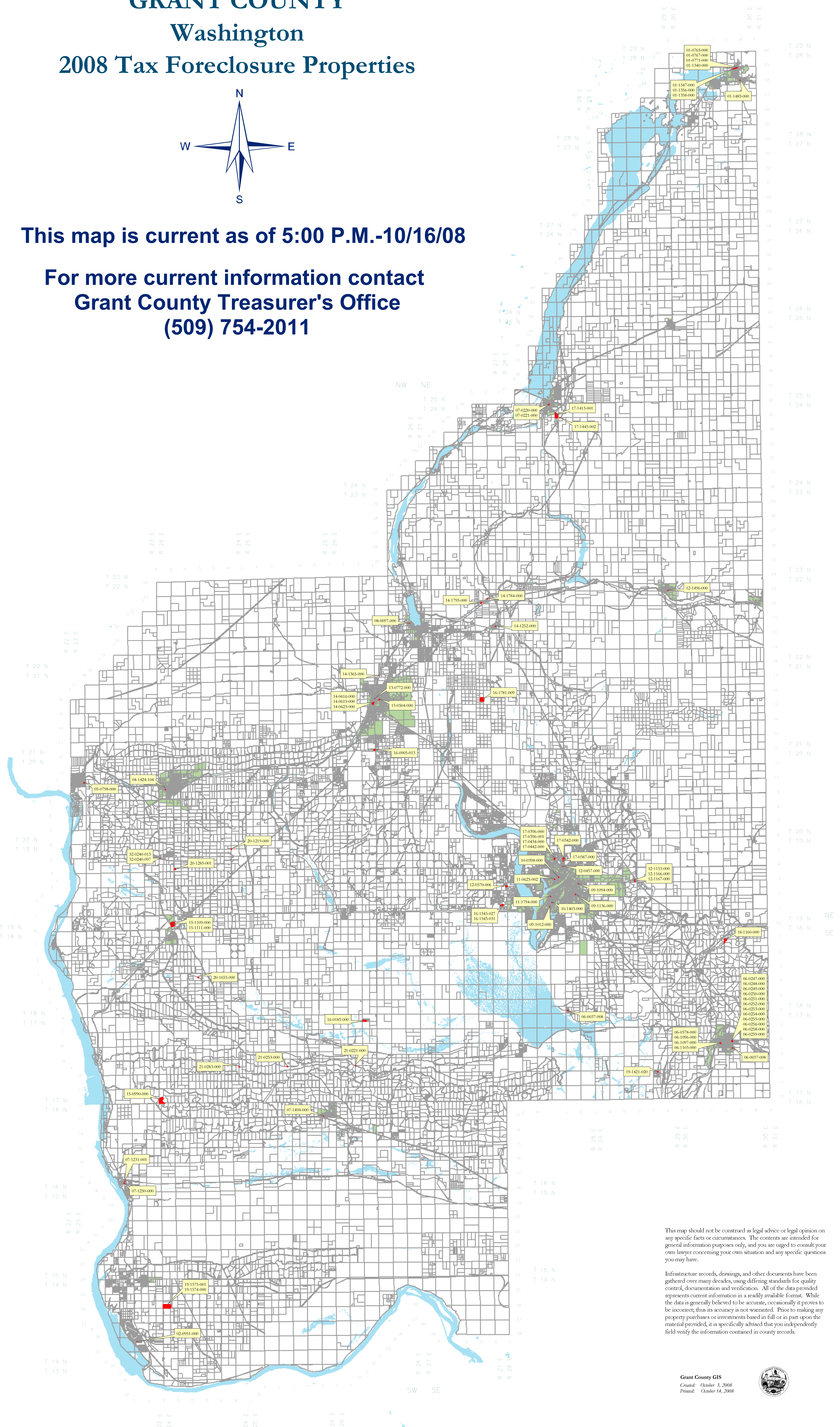

Removal Date	Parcel Number	Township Range Section	Improvements
/	01-0765-000	28-30-11	No
/	01-0767-000	28-30-11	No
/	01-0771-000	28-30-11	No
/	01-1340-000	28-30-11	No
/	01-1347-000	28-30-11	No
/	01-1356-000	28-30-11	No
/	01-1358-000	28-30-11	No
/	01-1485-000	28-30-11	Yes
10/07/08	02-0951-000	14-23-26	Yes
/	04-1424-104	20-24-18	No
/	05-0798-000	20-23-07	No
/	06-0037-008	18-28-35	Yes
/	06-0247-000	17-30-15	No
/	06-0248-000	17-30-15	No
/	06-0249-000	17-30-15	No
/	06-0250-000	17-30-15	No
/	06-0251-000	17-30-15	No
/	06-0252-000	17-30-15	No
/	06-0253-000	17-30-15	No
/	06-0254-000	17-30-15	No
/	06-0255-000	17-30-15	No
/	06-0256-000	17-30-15	No
/	06-0258-000	17-30-15	No
/	06-0259-000	17-30-15	No
/	06-0578-000	17-30-16	No
/	06-1096-000	17-30-16	No
/	06-1097-000	17-30-16	No
/	06-1103-000	17-30-16	No
10/09/08	06-1670-000	17-30-15	No
10/09/08	06-1671-000	17-30-15	No
/	07-0220-000	24-28-03	Yes
/	07-0221-000	24-28-03	Yes
/	07-1231-001	16-23-34	Yes
/	07-1250-000	16-23-34	No
/	07-1494-000	16-25-01	Yes
/	08-0097-000	22-26-24	No
/	09-1012-000	19-28-28	Yes
/	09-1094-000	19-28-23	Yes
/	09-1136-000	19-28-23	Yes
/	10-0398-000	19-28-15	Yes
/	10-1403-000	19-28-27	Yes
/	11-0625-002	19-28-15	No
/	11-1794-000	21-19-28	Yes
/	12-0457-000	19-28-10	Yes
10/07/08	12-0570-006	19-27-24	Yes
/	12-1153-000	19-29-16	No
/	12-1166-000	19-29-16	No
/	12-1167-000	19-29-16	No
/	12-1496-000	22-29-01	No
/	13-0504-000	21-26-15	No
10/17/08	13-0772-000	21-26-16	Yes
/	14-0616-000	21-26-16	Yes
/	14-0619-000	21-26-16	No
/	14-0625-001	21-26-16	Yes
/	14-1252-000	22-27-24	No
/	14-1365-000	21-26-03	No
/	14-1784-000	22-27-11	No
/	14-1795-000	22-27-11	No
/	15-0990-000	31-17-24	No
/	15-1109-000	31-19-24	Yes
/	15-1111-000	19-24-31	Yes
/	16-0185-000	04-17-26	No
/	16-0905-013	33-21-26	Yes
/	16-1545-027	19-27-25	Yes
/	16-1545-031	19-27-25	Yes
/	16-1781-009	21-27-14	No
/	17-0342-000	19-28-10	Yes
/	17-0387-000	19-28-10	Yes
/	17-0396-000	19-28-10	Yes
/	17-0396-001	19-28-10	Yes
/	17-0434-000	19-28-10	Yes
/	17-0442-000	19-28-10	No
/	17-1413-001	03-24-28	Yes
/	17-1445-002	24-28-11	No
/	18-1160-000	10-18-30	No
/	19-1421-020	17-29-26	No
/	19-1573-001	14-24-07	Yes
/	19-1574-000	14-24-07	Yes
/	20-1219-000	19-24-01	No
/	20-1285-001	19-24-08	Yes
/	20-1655-000	18-24-21	No
/	21-0221-000	17-26-20	No
/	21-0253-000	17-25-21	No
/	21-0283-000	17-24-24	No
10/14/08	32-0240-013	19-24-07	Yes
/	32-0240-097	19-24-07	Yes

This map should not be construed as legal advice or legal opinion on any specific facts or circumstances. The contents are intended for general information purposes only, and you are urged to consult your own lawyer concerning your own situation and any specific questions you may have.

Infrastructure records, drawings, and other documents have been gathered over many decades, using differing standards for quality control, documentation and verification. All of the data provided represents current information in a readily available format. While the data is generally believed to be accurate, occasionally it proves to be incorrect; thus its accuracy is not warranted. Prior to making any property purchases or investments based in full or in part upon the material provided, it is specifically advised that you independently field verify the information contained in county records.